

RAILWAYS Range

BOX

www.tagmaster.com
contact@tagmaster.com

BOX81 3232

DESCRIPTION

The housing BOX81 3232 is used to protect equipments as OMR81C commutable beacon, DMOL81sensor, or ERES81 1353 monoblock dialogue product, against mechanical stress.

It is specifically designed to be installed into road, traffic zones or passage area, where equipment must be embedded into ground or into ballast.

The equipment to protect is fixed to the bottom of the BOX81 3232 by 4 screws M6.
After fixing the equipment, it is possible to use a gel to coat it, and get a better protection against standing water.

All different accessories are supplied for the different uses with the different equipments.

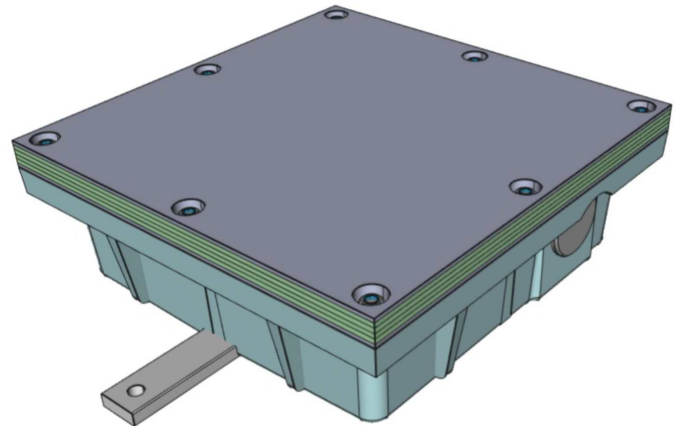

< These photographs can in no way be considered contractual >

DATA

CASE :

- polyester resin filled with glass fiber

TAP :

- rough non-slip coating
- suitable for vehicle passing through
- secured by 8 M8 hexagonal stainless steel brake nuts grade A4, associated with 6 stainless steel washers grade A4
- fastening torque : 5 N.m
- colours : Black RAL9005

GASKET :

- closed cell neopren foam

- Operating temperature : -30°C to +70°C
- IP : the index of protection is ensured by the equipment itself (IP67) be carefull that no water stagnates inside the BOX81 3232.

To ensure no stagnate water inside the box, it is recommended to fill the box around the equipment with a coating gel.

- Typical mass : tbd

The BOX81 3232 is designed to comply with the load level of 60kN (6 tons) in accordance with standard EN124 : test to be done.

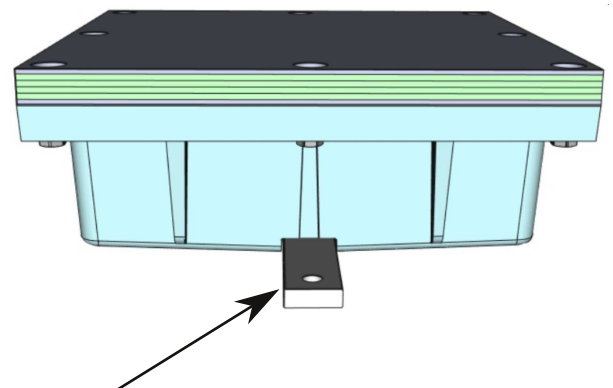

Anchoring bar to maintain BOX81 3232 after pouring the concrete or bitumen.
The anchoring bar is not providing to fix the box directly on the ground, it stabilizes the box when embedded.

< These photographs can in no way be considered contractual >

TagMaster

LEARN FROM REALITY

DIMENSIONS

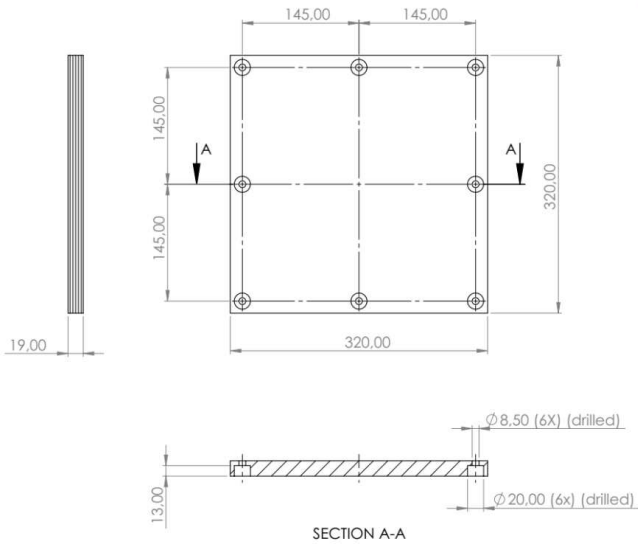
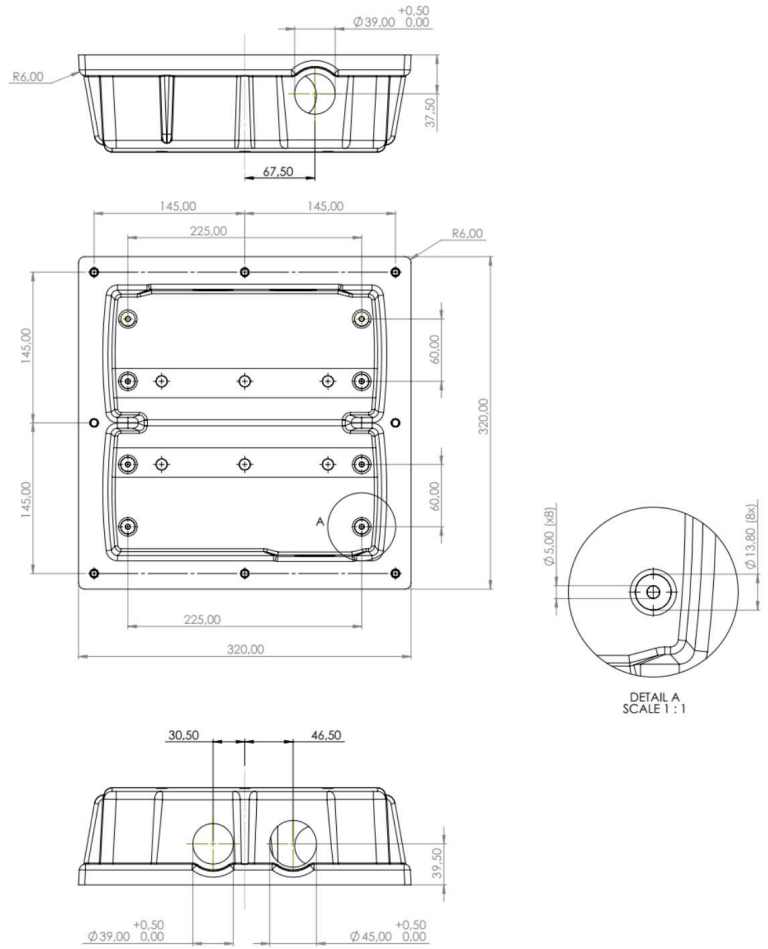

TagMaster

LEARN FROM REALITY

Use with DMOL81 sensor

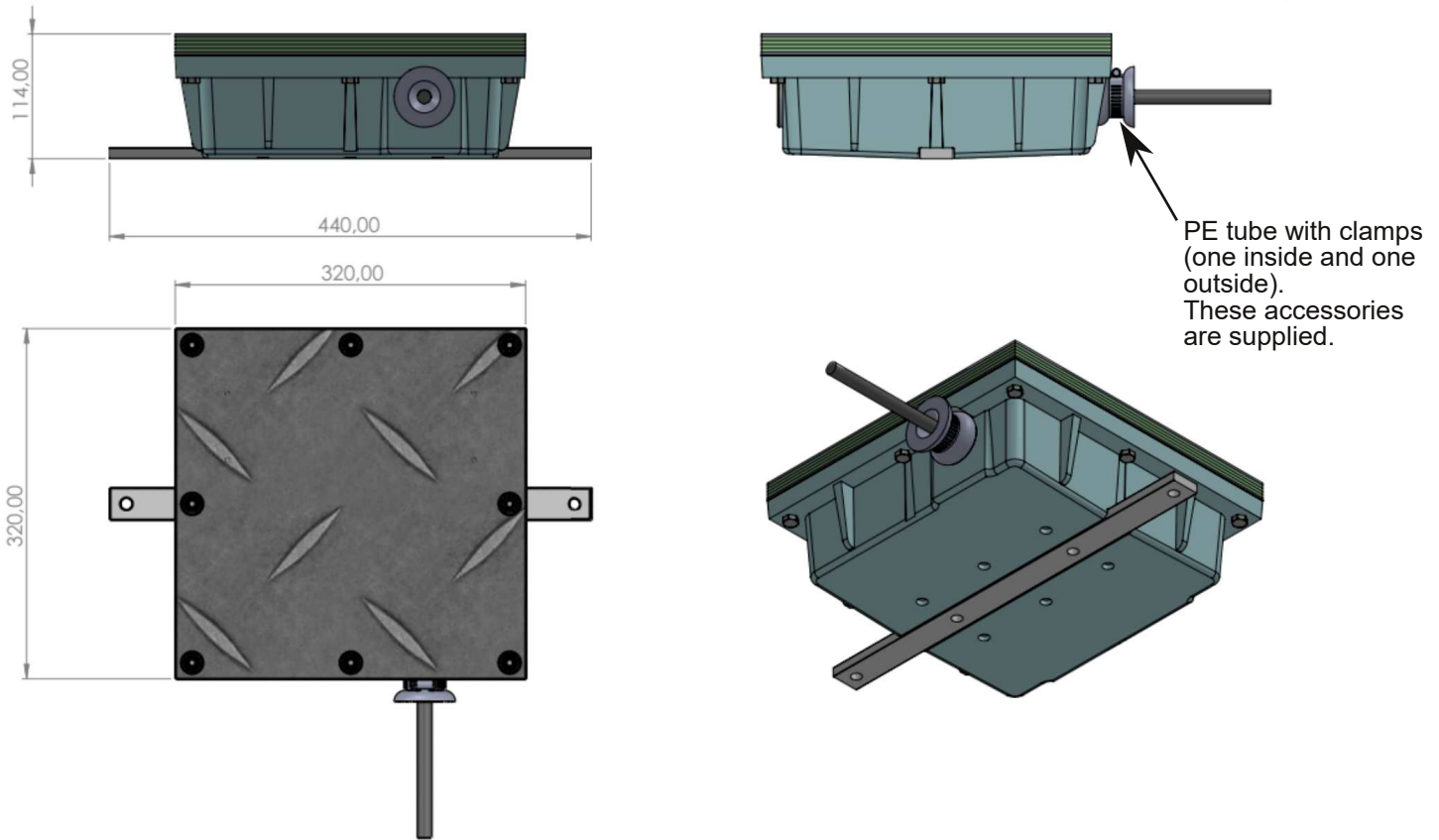

Mounting

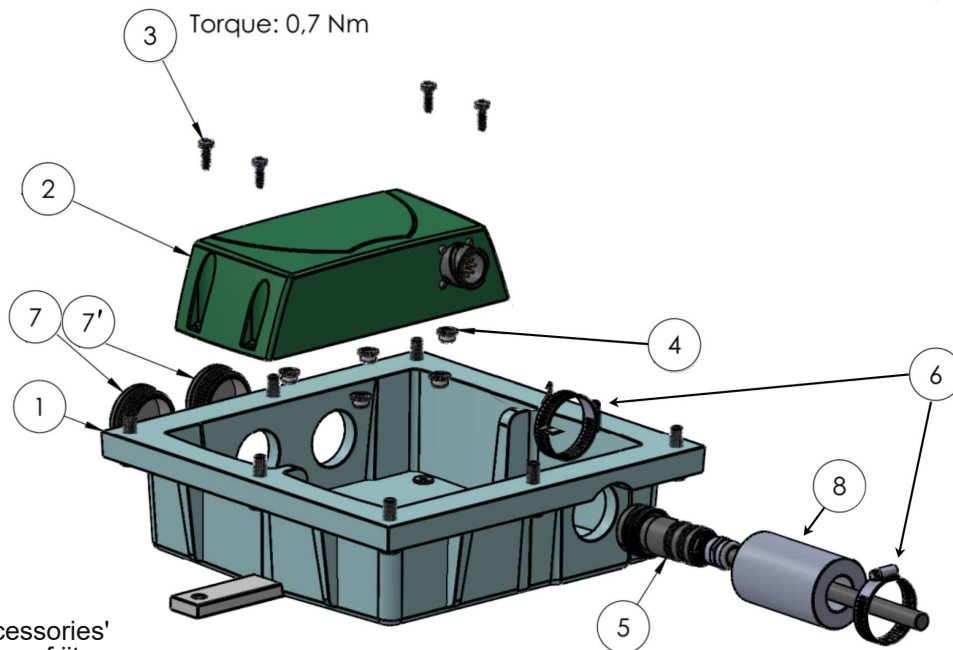

See page 6 'Accessories' for the description of item numbers

Use with OMR81C commutable beacon

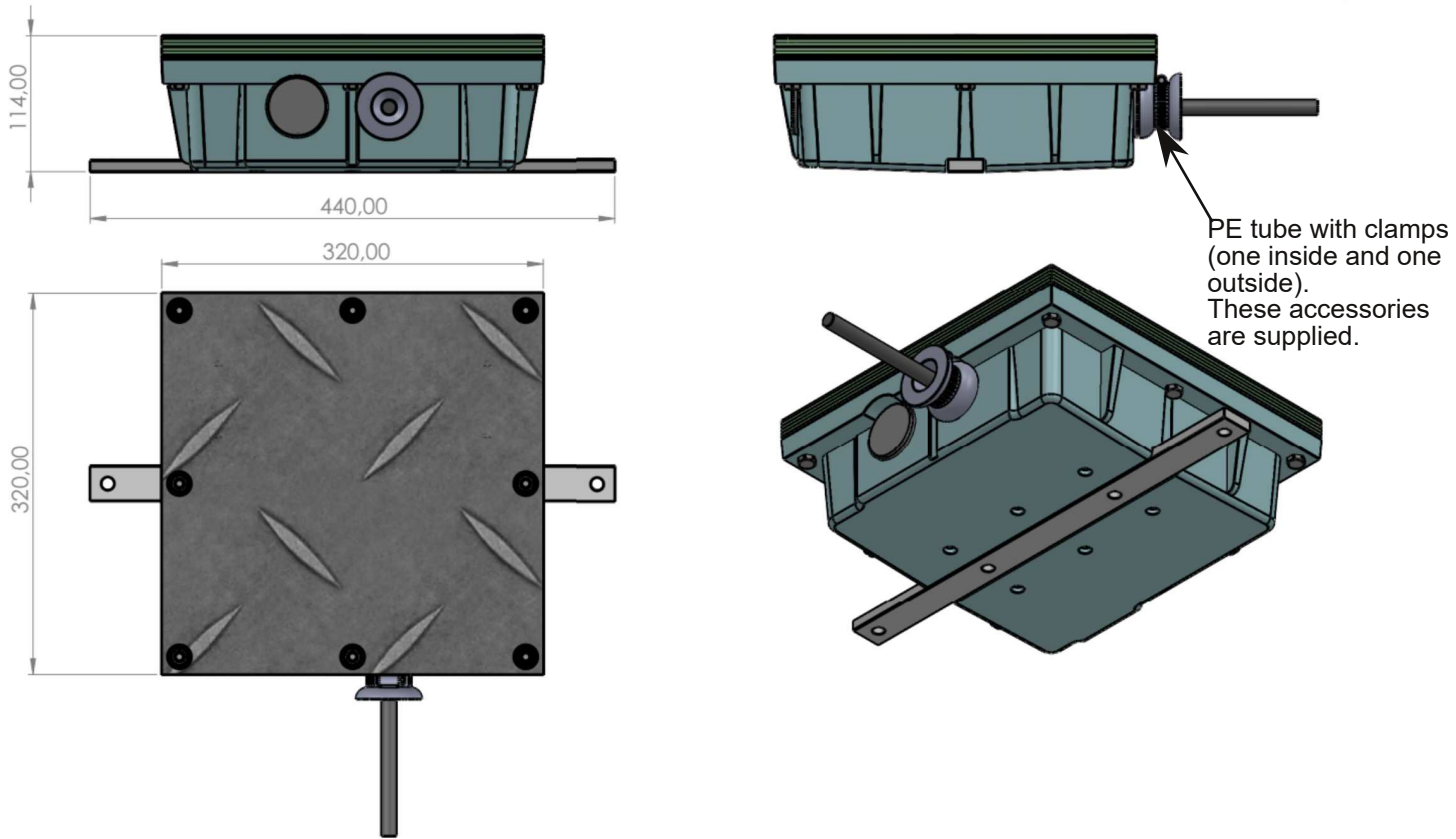

Mounting

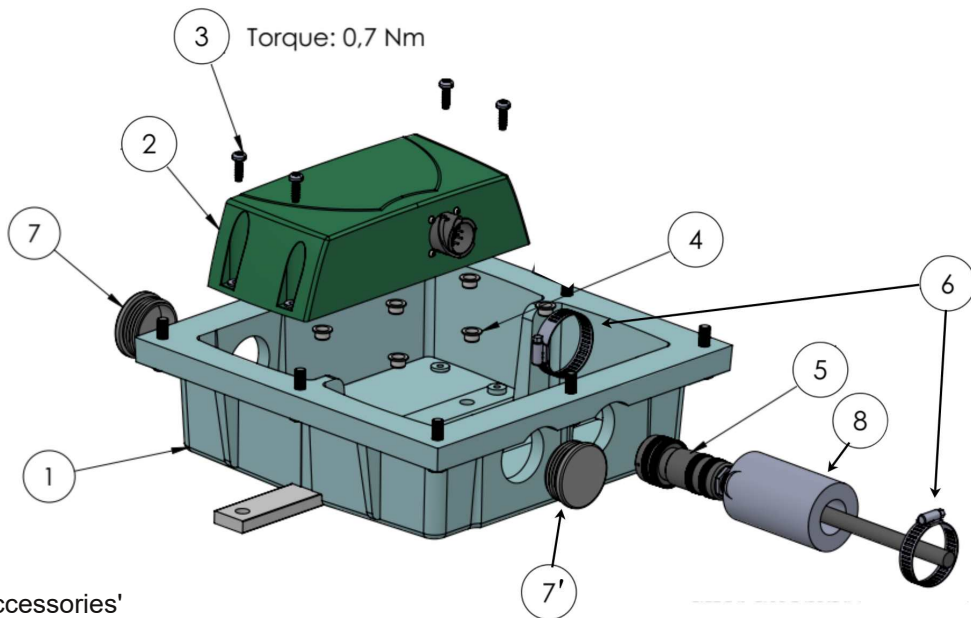

See page 6 'Accessories' for the description of item numbers

Use with ERES81 1353 monoblock dialogue equipment

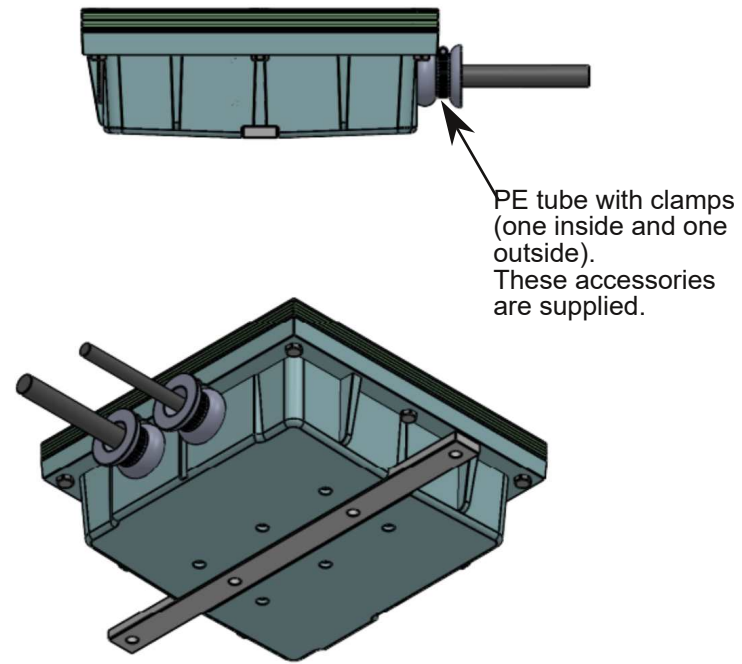
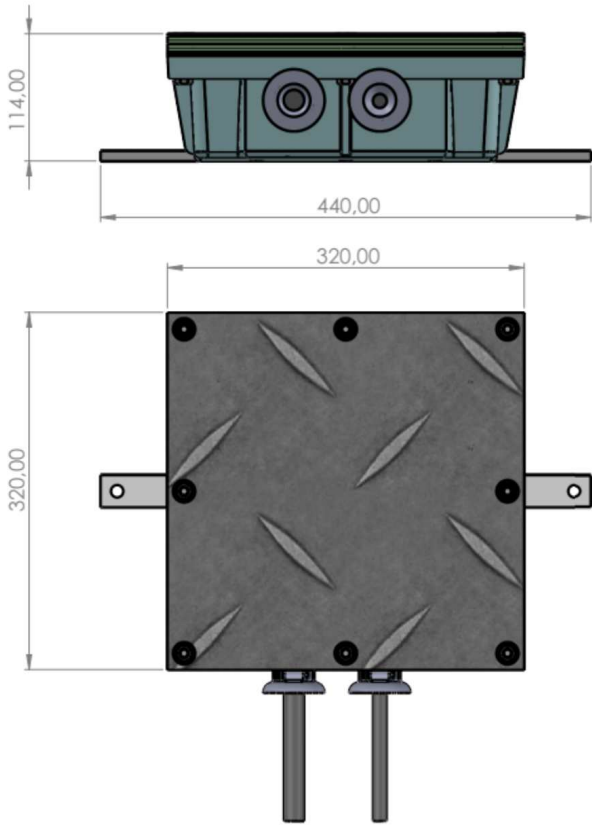

Mounting

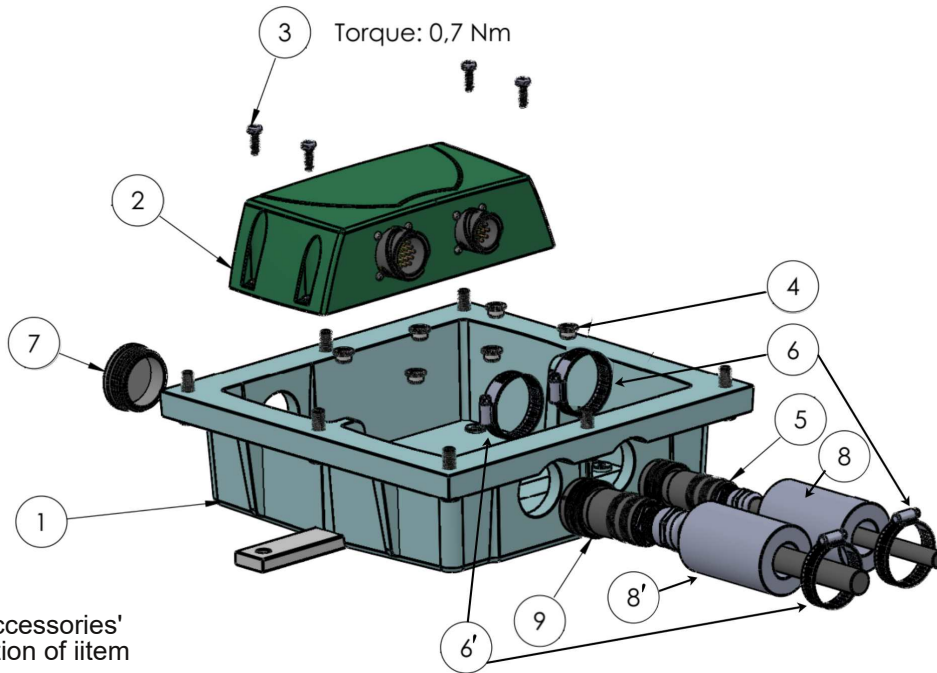

See page 6 'Accessories' for the description of item numbers

Accessories

Item number	Description	Supply with BOX81 3232	Quantity delivered
1	BOX	yes	1
2	Equipment (DMOL81 or OMR81C or ERES81 1353)	no	0
3	Screw M6 (STP60x18 A2 Type20166)	yes	4
4	Plastic plug Ø11mm (*)	yes	6
5	VG1-D-18-19SN-Straight Connector	no	0
6 & 6'	Clamp M316-024 Regular A4	yes	4
7 & 7'	Plastic plug IF5144-47S	yes	2
8 & 8'	PE Tube Ø54mm	yes	2
9	VG1-D-22-14SN-Straight Connector	no	0
10	Plate EPDM gasket 320x320	yes	1
11	Top lock	yes	1
12	Washer M8	yes	8
13	Safety nut 085 A4 M8	yes	8

(*) The plastic plugs Ø11mm are used when using a gel to coat the BOX81 3232.
When the BOX81 3232 is not coated, do not put the plastic plugs Ø11mm to obtain water drainage.

Examples of installation

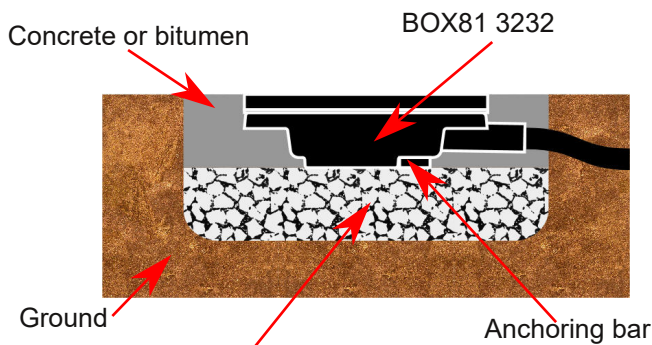

To ensure correct draining, it is recommended to put the BOX81 3232 onto a bed of gravel before holding it with concrete or bitumen

Example of metallic bars to fix the box

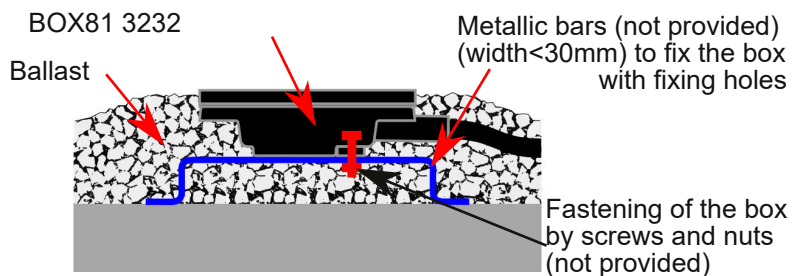

Example of metallic bars to fix the box, the bars can be fixed on the sleepers

